

REVISIONS				
ZONE	REV.	DESCRIPTION	DATE	APPROVED
E7	P2	Removed dimension	11/11	JBB
	P2	Updated to latest configuration	11/11	JBB

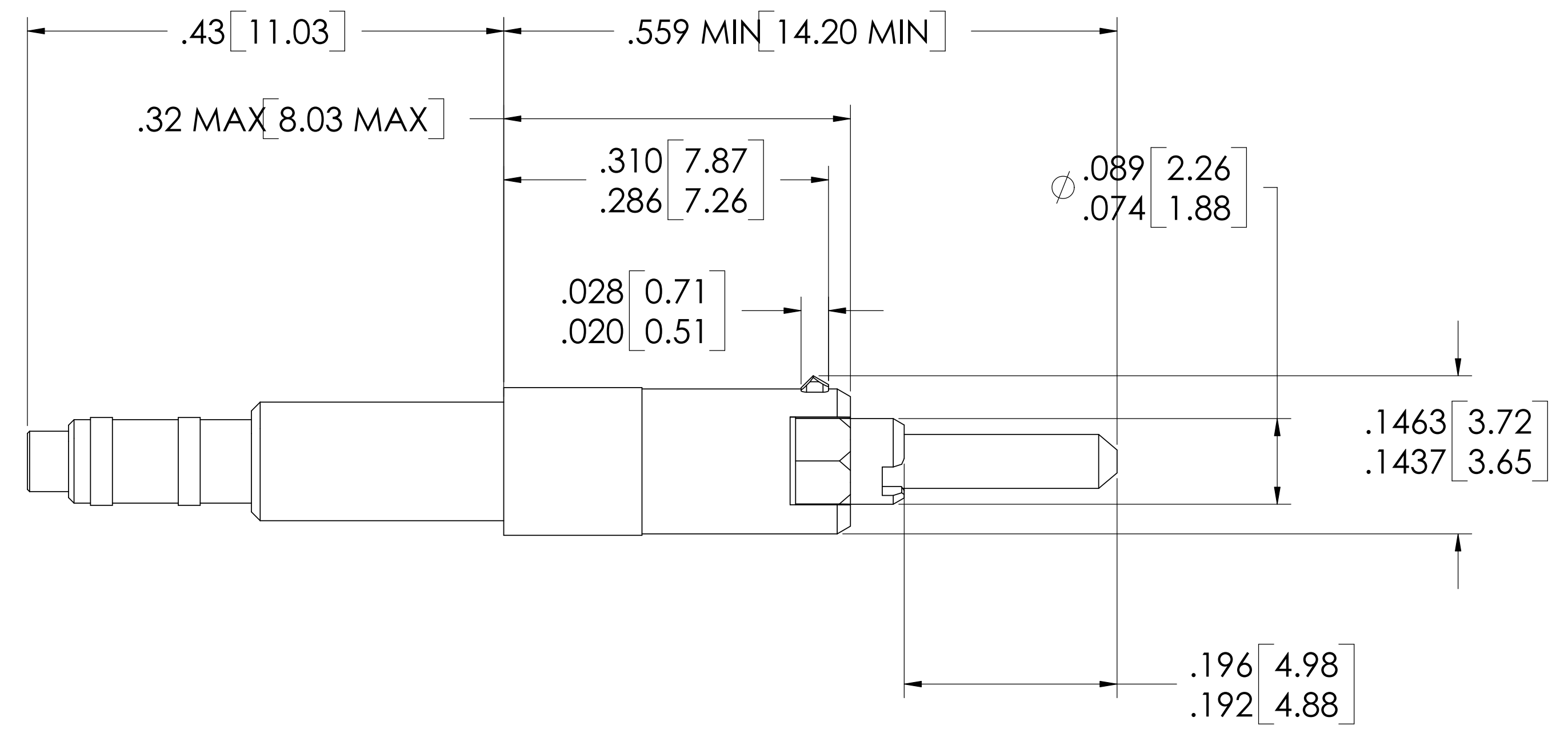
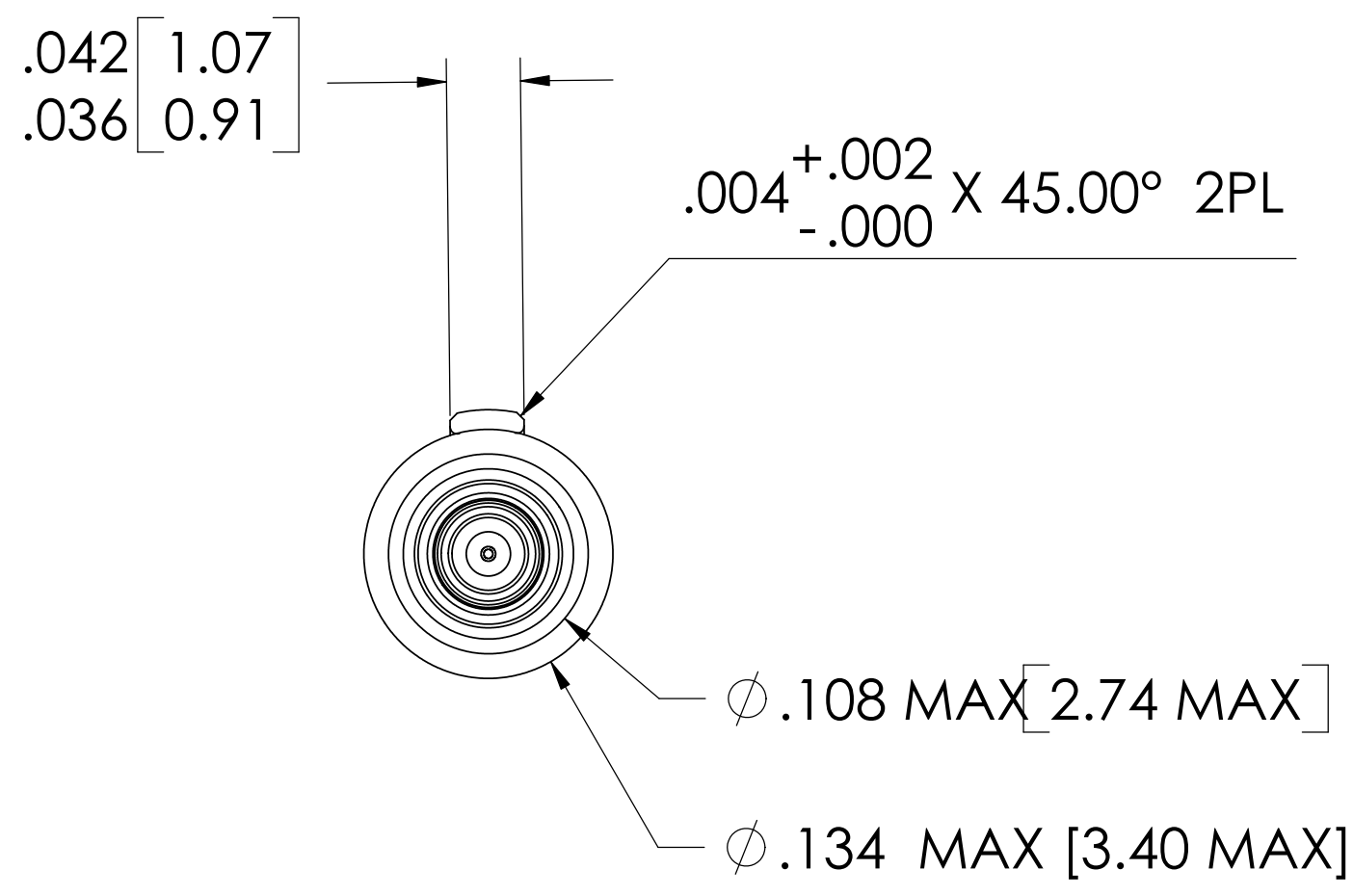

ASSEMBLY CONFIGURATION PART NUMBERING

TA-1250-S-N900

- N900: Non Pull Proof, 900 Micron Tube
- S: Single Mode Preciso (0.5 um tolerance), M: Multi-mode Precision (1.0 um tolerance)
- Ferrule Hole Diameter: SM: 1250, 1255, 1260, 1265, 1270 MM: 1250, 1260, 1270, 1430, 2120
- Terminus Code: Terminus Assembly

NOTES: UNLESS OTHERWISE SPECIFIED

1. DIMENSIONS ARE IN INCHES[MILLIMETERS].
2. MATERIALS AND FINISHES:
 FERRULE: ZIRCONIA CERAMIC, FUNCTIONAL ENDFACE DIMENSIONS PER TIA/EIA 604-10A
 BODY: ALLOY CORROSION RESISTANT STEEL
 INTERNAL BODY: BRASS ALLOY
 PASSIVATION: PER SAE-AMS-QQ-P-35 OR ASTM-A-967
 NICKEL PLATING: ELECTROLESS 200 MICRORINCH MIN
 *ALL MATERIALS, PLATINGS AND FINAL ASSEMBLY ARE COMPLIANT TO ROHS DIRECTIVE 2002/95/EC OF JAN 27, 2003
3. WHERE APPLICABLE FEATURES ARE COMPLIANT TO ARINC801 SPECIFICATIONS
4. CABLE DIAMETER: APPLICABLE RANGE FOR 900 MICRON JACKETED CABLE, LOOSE OR TIGHT STRUCTURE, 1 INCH SECTION OF MIL-I-23053/12 SHRINK TUBING PROVIDED FOR USE AS APPLICABLE TO SLEEVE EXPOSED 900 JACKET SIZE TO NOMINAL DIAMETER OF 0.10 INCH AT INTERFACE TO GROMMET SEALS.
5. END FACE GEOMETRY POST POLISH MUST MEET THE REQUIREMENTS OF TELCORDIA GR-326 FERRULE EXTENSION SHALL NOT BE LESS THAN 0.192 INCH POST POLISH
6. PACKAGING:FOD FREE, ESD OVERALL PACKAGE

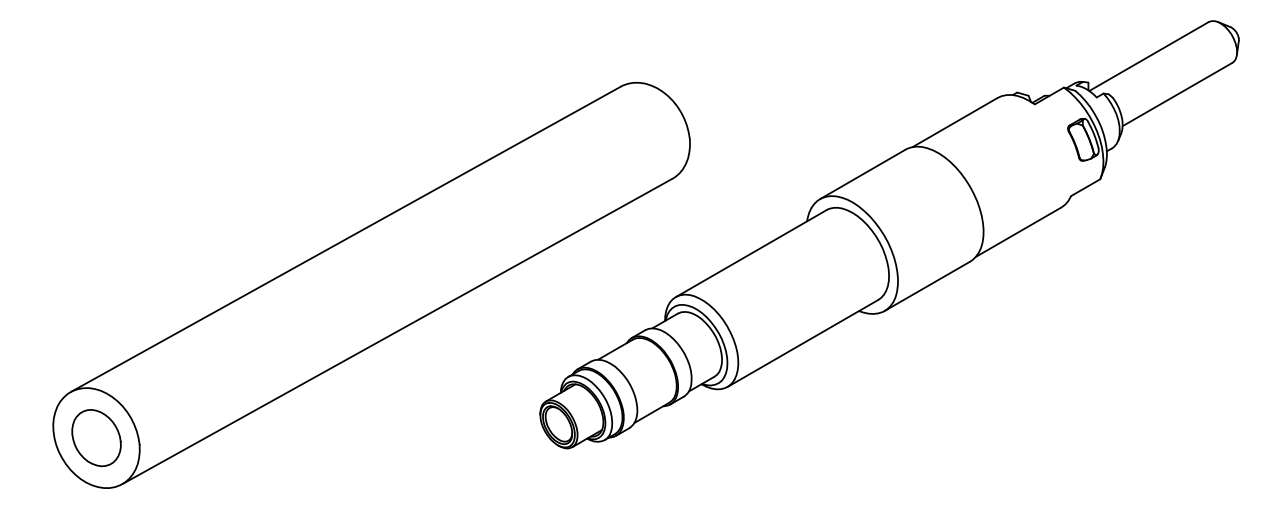

HEAT SHRINK SLEEVE AND TERMINUS 3D IMAGE FOR REFERENCE ONLY

CUSTOMER USE

PROPRIETARY AND CONFIDENTIAL		UNLESS OTHERWISE SPECIFIED:		DATE	NAME	
THE INFORMATION CONTAINED IN THIS DRAWING IS THE SOLE PROPERTY OF NXTCON. ANY REPRODUCTION IN PART OR AS A WHOLE WITHOUT THE WRITTEN PERMISSION OF NXTCON IS PROHIBITED.		DIMENSIONS ARE IN INCHES		10/10	J. B.	
		TOLERANCES:		DRAWN		
		FRACTIONALS: 1/16, 1/8, 1/4, 1/2, 3/4, 1		CHECKED		
		DECIMALS: .005, .01, .02, .03, .04, .05, .06, .07, .08, .09, .10, .15, .20, .25, .30, .35, .40, .45, .50, .55, .60, .65, .70, .75, .80, .85, .90, 1.00, 1.50, 2.00, 3.00, 4.00, 5.00, 6.00, 8.00, 10.00		ENG APPR:		
INTERPRET GEOMETRIC TOLERANCING PER:		MFG APPR:				
MATERIAL:		Q.A.				
FINISH:		COMMENTS:				
NEXT ASSY	USED ON	APPLICATION	DO NOT SCALE DRAWING			

ASSEMBLY, NXTCore (900 MICRON)	
SIZE D	DWG. NO. TA0003
SCALE: 20:1	REV P3
WEIGHT:	SHEET 1 OF 1