

THE INFORMATION CONTAINED IN THIS DRAWING IS THE SOLE PROPERTY OF WRAITHCON. ANY REPRODUCTION IN PART OR AS A WHOLE WITHOUT THE WRITTEN PERMISSION OF XIOPTICS IS PROHIBITED.

$\phi$ .131 [3.33]  
 $\phi$ .127 [3.23]

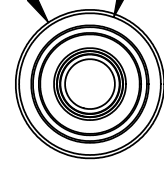

$\phi$ .123±.002 [3.12±0.05] BONDING CUP ID

STAINLESS STEEL BODY

.033 [0.84]  
.029 [0.74]

ALIGNMENT SLEEVE SUB-ASSEMBLY  
AVAILABLE AS SEPARATE ITEM,  
XOHA0001 , SEE NOTE 3

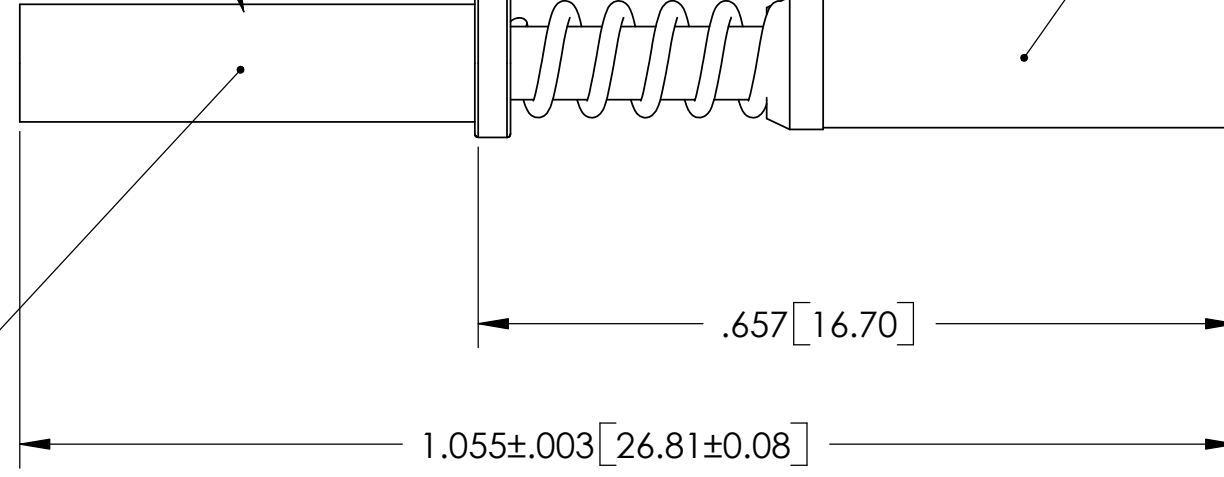

PLASTIC OPTICAL FIBER CABLE BONDING CUP  
SEE TERMINATION INSTRUCTIONS  
FOR PROPER STRIP BACK AND  
PREPARATION.

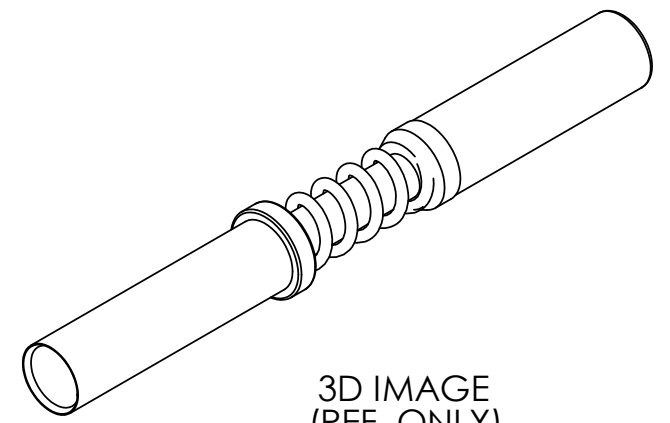

3D IMAGE  
(REF. ONLY)

UNLESS OTHERWISE SPECIFIED:

- 1) ALL METALLIC COMPONENTS ARE CRS ALLOY, PASSIVATED
- 2) SOCKET ASSEMBLY SHIPPED WITH REMOVAL BE HOOD ASSEMBLY INSTALLED, IF INDIVIDUAL HOOD ASSEMBLIES ARE REQUIRED ORDER P/N XOHA0001
- 3) DIMENSIONS ARE INCHES [MM]

UNLESS OTHERWISE SPECIFIED:		NAME	DATE	<b>XiOptics LLC</b>	
DIMENSIONS ARE IN INCHES AND [MM]		DRAWN	J. B.		
TOLERANCES:		CHECKED			TITLE: <b>29504 /5 PLASTIC OPTICAL FIBER SOCKET ASSEMBLY</b>
ANGULAR: MACH ± 1 BEND ± 3		ENG APPR.			
TWO PLACE DECIMAL ± .01		MFG APPR.			
THREE PLACE DECIMAL ± .005		Q.A.			SIZE DWG. NO. REV <b>B</b> XOPOFS0001CU CU1
FOUR PLACE DECIMAL ± .0005		COMMENTS:			
INTERPRET GEOMETRIC TOLERANCING PER: ANSI Y14.5M					SCALE: 4:1 WEIGHT: SHEET 1 OF 1
MATERIAL SEE NOTES					
FINISH SEE NOTES					
DO NOT SCALE DRAWING					